

公制内螺纹24°锥带O形圈重系列
METRIC FEMALE 24° CONE O-RING H.T.

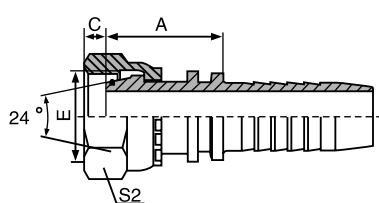

DKOS

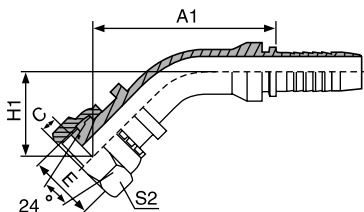

DKOS45

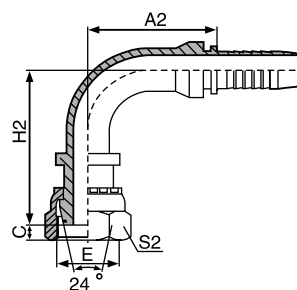

DKOS90

订货代号	螺纹E	软管		尺寸					管子外径
		通径DN	标号	A	C	S2	A1/H1	A2/H2	
DKOS**-16-04	M16*1.5	6	-4	29	1.5	22	50.4/28.3	30/48	8
DKOS**-18-04	M18*1.5	6	-4	26.5	2	22	43.4/21.3	30/39.5	10
DKOS**-20-05	M20*1.5	8	-5	28.5	2.5	24	48.1/24.3	33.5/44	12
DKOS**-22-06	M22*1.5	10	-6	28.5	2.5	27	49.6/25.3	35.3/46.8	14
DKOS**-24-08	M24*1.5	12	-8	30	3	30	62.5/27.5	41/53	16
DKOS**-30-10	M30*2	16	-10	36	3	36	75.8/31	56.5/60.5	20
DKOS**-36-12	M36*2	20	-12	36	3	41	82.7/34.6	66.2/70	25
DKOS**-42-16	M42*2	25	-16	41	5	50	92.3/36.8	78/77.5	30
DKOS**-52-20	M52*2	32	-20	44	6.5	60	103.4/41.2	93/89	38

公制外螺纹24°内锥面重系列
METRIC MALE 24° CONE SEAT H.T.

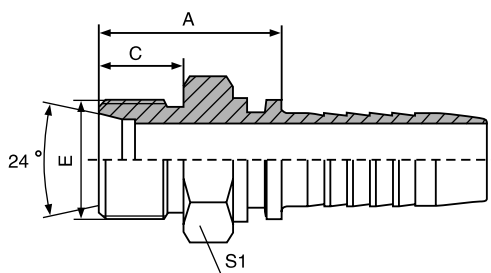

CES

订货代号	螺纹E	软管		尺寸					管子外径
		通径DN	标号	A	C	S1			
CES-14-04	M14*1.5	6	-4	24.1	12	14			6
CES-16-04	M16*1.5	6	-4	26.5	12	17			8
CES-18-04	M18*1.5	6	-4	26	12	19			10
CES-20-05	M20*1.5	8	-5	27	12	22			12
CES-22-06	M22*1.5	10	-6	30.5	14	24			14
CES-24-08	M24*1.5	12	-8	31.5	14	27			16
CES-30-10	M30*2	16	-10	36	16	32			20
CES-36-12	M36*2	20	-12	40.5	18	41			25
CES-42-16	M42*2	25	-16	44	20	46			30
CES-52-20	M52*2	32	-20	50	22	55			38